

Combiner box ASW1000-CB-HB

Quick Installation Guide

Version:02

1 GENERAL INFORMATION

This quick installation guide does not replace the descriptions and content within the user manual. The contents of this guide may be updated or revised due to product development. The information in this guide is subject to change without notice. The latest version of this document and the manual for installation, commissioning, configuration and decommissioning are to be found in PDF format at www.solplanet.net.

2 SAFETY

2.1 Intended use

The product must only be used in countries for which it is approved or released by Solplanet.

Use this product only in accordance with the information provided in this documentation, the user manual and with the locally applicable standards and directives. Any other application may cause personal injury or property damage.

The type label must remain permanently attached to the product.

This document does not replace any regional, state, provincial, federal, or national laws, regulations or standards that apply to the installation, electrical safety and use of the product.

2.2 Important safety instructions

The product has been designed and tested in accordance with international safety requirements. As with all electrical or electronical devices, there are residual risks despite careful construction. To prevent personal injury and property damage and to ensure long-term operation of the product, read this section carefully and always observe all safety information.



DANGER

Danger to life due to high voltage of the Combiner Box!

High voltages are present in the live components of the Combiner Box. Touching live components results in serious injury or death due to electric shock.

- Wear personal protective equipment when working on the Combiner Box.
- Do not touch live components.
- Before performing any work, always disconnect the Combiner Box from voltage sources and ensure that no voltage is present. Cover or isolate any adjacent live components. Protective covers must always be mounted.



DANGER

Danger to life from electric shock if the Combiner Box is damaged!

If the Combiner Box is damaged, dangerous situations may arise during operation that results in serious injury or death from electric shock.

- Only use the Combiner Box when it is in a technically faultless condition and safe to operate.
- Regularly check the Combiner Box for visual damage.
- Ensure that all external safety equipment is freely accessible at all times.
- Ensure that all safety equipment is in good working order.

2.3 Symbols on the label



Beware of high voltage and operating current!
The product operates at high voltage and current. Work on the product must only be carried out by skilled and authorized electricians.



Beware of hot surfaces
The product may become hot during operation. Avoid contact during operation.



WEEE Designation
Do not dispose of the product together with household waste. Dispose the product in accordance with local disposal regulations for electronic waste.



CE marking
The product complies with the requirements of the applicable EU directives.



RCM Mark
The product complies with the requirements of the applicable Australian standards.



Capacitor discharge
Danger to life due to high voltages in the product. Do not touch live parts for 10 minutes after disconnection from the power sources.



Observe the documentation
Observe all documentation supplied with the product.

3 Eu Declaration Of Conformity

Within the scope of the EU directives

- Restriction of the use of certain hazardous substances

2011/65/EU (L 174/88, June 8, 2011) and 2015/863/EU

(L 137/10, March 31, 2015) (RoHS)

- Low voltage directive 2014/35/EU (L 96/357-374, March 29, 2014)(LVD)



AISWEI New Energy Technology (Yangzhong) Co., Ltd. confirms herewith that the combiner box described in this manual is in compliance with the fundamental requirements and other relevant provisions of the above mentioned directives.

The entire EU Declaration of Conformity can be found at www.solplanet.net.

4 Overview

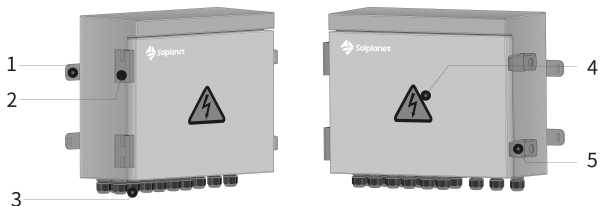

No.	Name
1	Mounting ears
2	Hinge
3	Wiring area
4	Label
5	Lock

5 Scope of Delivery

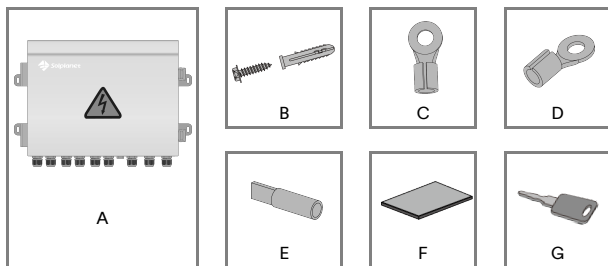

+

NO.	Name	Quantity
A	ASW1000-CB-HB	1 unit
B	M8*40 Expansion Anchor Bolt	4 pieces
C	Terminals RNB8-6	5 pieces
D	Terminals RNBS5.5-4	8 pieces
E	Terminals C45-10	2 pieces
F	Documents	1 piece
G	Key	4 pieces

6 Mounting Environment

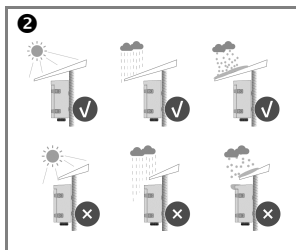
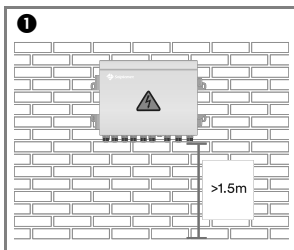

7 DIMENSIONS

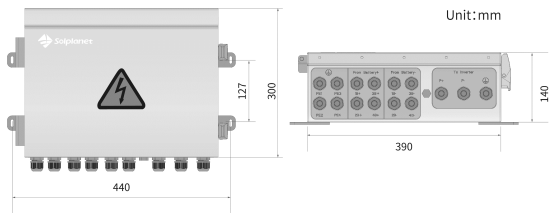

8 Mounting

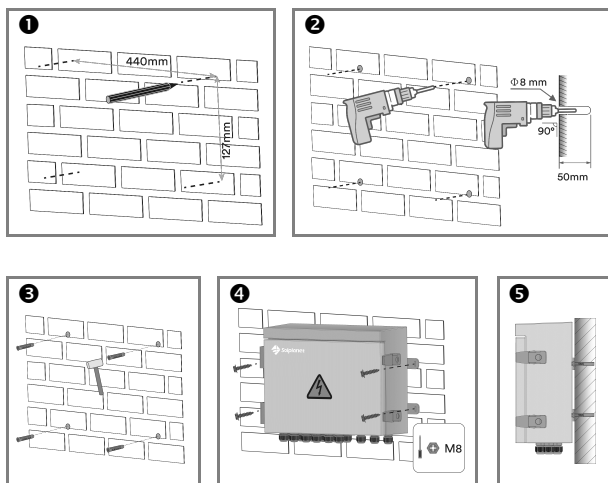

9 Preparation Before Wiring

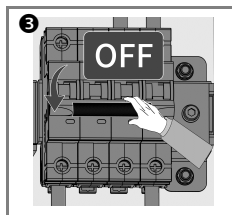
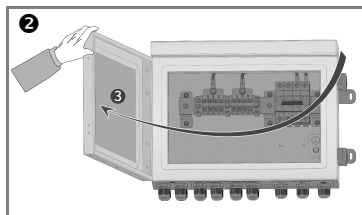
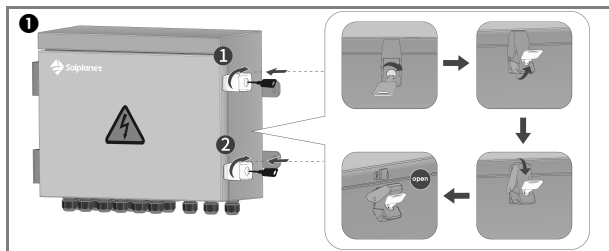

10 Connection Instructions

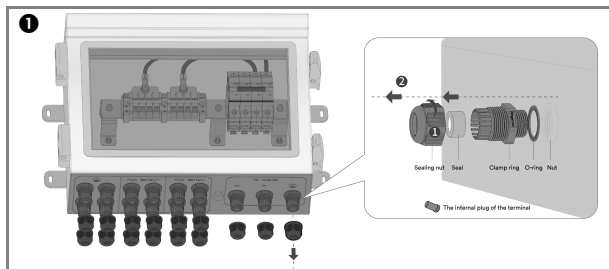

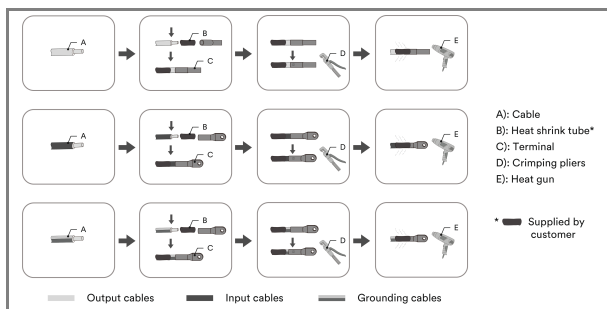
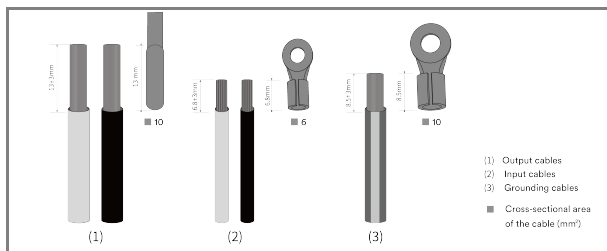
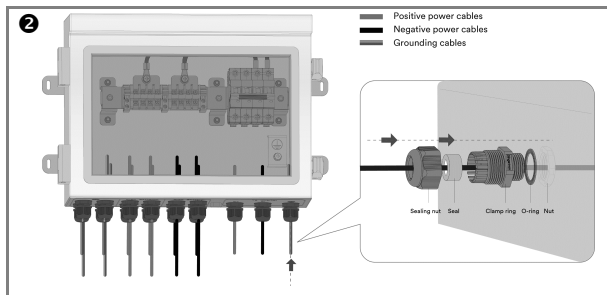

11 Cable connection

Connect the ground wire

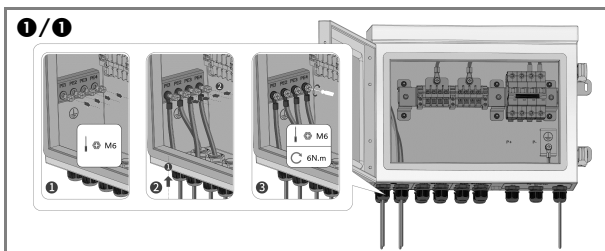

Connect battery input wiring (from batteries)

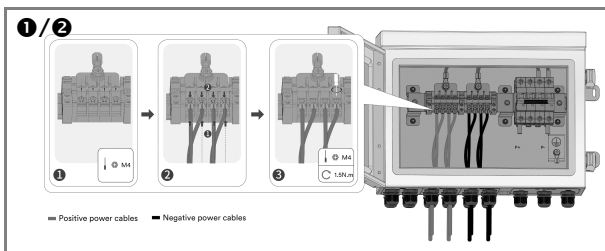

Connect battery output wiring (to inverter)

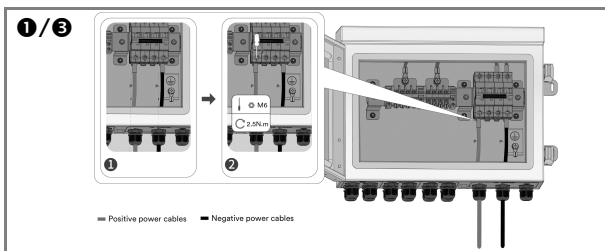

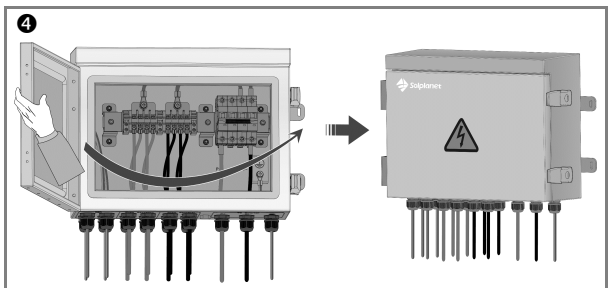
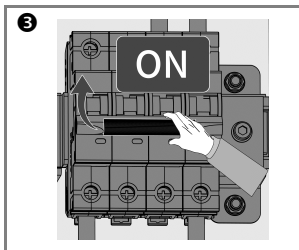
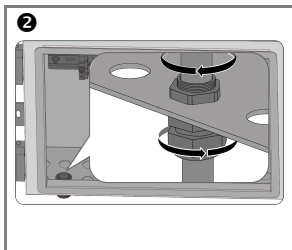

12 Contact

If you have any technical problems concerning our products, please contact Solplanet service. We require the following information in order to provide you with the necessary assistance:

- Combiner Box serial numbers
- Combiner Box type and model
- Battery serial numbers
- Battery type and model
- Inverter device type
- Inverter serial number
- Mounting location
- Installation date
- Warranty card

EMEA

Service email: service.EMEA@solplanet.net

APAC

Service email: service.APAC@solplanet.net

LATAM

Service email: service.LATAM@solplanet.net

AISWEI New Energy Technology (Yangzhong) Co., Ltd.

Hotline: +86 400 801 9996

Add.: No.588 Gangxing Road, Yangzhong Jiangsu, China

<https://solplanet.net/contact-us/>



AISWEI Technology CO., Ltd